



## BOROUGH OF GORE

### Application for Permit for Sanitary Plumbing or Drainage Work

Application No. 3004  
Received .....  
Permit No. 874  
Issued 3-10-73  
Fees Payable:  
Plumbing ..... \$ :  
Drainage ..... \$ 9.00  
Street Reinstat. .... \$ :  
Sewer Con. .... \$ :  
Storm Water Con. \$ :  
Water Con. .... \$ :  
**TOTAL** 9.00 ✓

TO THE BOROUGH ENGINEER,

I, the undersigned **GORE PLUMBING & SHEETMETAL CO. LTD.** of .....  
(Name in full)

hereby apply for permission for the work described herein, and set out in the plans attached hereto, to be carried out in the premises situated in Long Vining + Weyland St  
(Address in full)

#### DESCRIPTION OF PROPERTY:

Lot No. 45  
D.P. No. .... Block No. ....  
Section No. .... Town or Survey District .....

Name and address of Person for whom work is to be carried out:

(Name) M. Treacy  
(Address) .....

Name and address of Registered Plumber or other person entitled to do the work:

(Name) R. H. Ellison  
(Address) 270 Bex 14 Geo.

#### DESCRIPTION OF WORK:

State if New Work or Repairs .....  
Sanitary Fittings to be installed .....  
Approximate Length of Drain .....  
State if Street Opening .....  
Is a Water Connection required, Yes/No.  
Value of Proposed Work Including Materials  
Estimated Value of (a) Plumbing ..... \$ :  
(b) Drainage ..... \$ :

**TOTAL** \$ 750.00

**GORE PLUMBING & SHEETMETAL CO. LTD.**  
Signature R. H. Ellison  
(Registered Plumber/Drainlayer)

Dated this 23rd day of August 19 73.

#### FOR OFFICE USE ONLY:

##### Health Inspector's Report

1. Application Approved for Issue of Permit.
2. Application Deferred.

Date 24.8.73

Date 3.9.73

Health Inspector.

Borough Engineer.



Fees Payable on the Issue of Drainage Permit  
according to the Estimated Value of the Work

PLUMBING and DRAINAGE—

Not Exceeding \$50	.....	.....	.....	.....	\$1.00
„ \$50 to \$100	.....	.....	.....	.....	\$2.00
„ \$100 to \$200	.....	.....	.....	.....	\$3.00
„ \$200 to \$300	.....	.....	.....	.....	\$4.00
„ \$300 to \$400	.....	.....	.....	.....	\$5.00
„ \$400 to \$600	.....	.....	.....	.....	\$6.00
„ \$600 to \$800	.....	.....	.....	.....	\$7.00
„ \$800 to \$1000	.....	.....	.....	.....	\$8.00

Plus \$1.00 per \$200 thereafter.

STREET REINSTATEMENT—

Bitumen	.....	.....	.....	.....	\$24.00
Gravel	.....	.....	.....	.....	\$7.00

WATER FEES:

	Sealed Roads	Gravel Roads
¾"	\$48.00	\$24.00
1"	\$50.00	\$26.00
1½"	\$56.00	\$32.00

FEE\$ PAYABLE FOR SPECIAL DUTIES

Nature of Duty	Fees
----------------	------



# House Connection Plan-Drainage

All drawings must be correct to Scale, in INK, and show Compass direction, land boundaries and all necessary information.

Scale:  $\frac{1}{4}$  in. to 1 ft.

To be submitted in DUPLICATE.

## REFERENCES—

AB Access Bend

AP Access Pipe

AY Access Y Junction

BV Back Vent

DP Down Pipe

New Sewer Drains: RED

FAI Fresh Air Inlet

GA Grease Arrester

GT Gulley Trap

IC Inspection Chamber

New Stormwater Drains:

DOTTED BLACK

MV Main Vent

S Saddle

TV Terminal Vent

WC Water Closet

Old Drains: FULL BLACK

THIS PERMIT IS SUBJECT TO THE WORK BEING  
CARRIED OUT IN ACCORDANCE WITH THE S.L.A.V.S.  
Engineer  
Date  
Building Inspector  
Date  
Health Inspector  
Date

APPROVED  
GORE BOROUGH COUNCIL

SW & sewer to  
connection existing

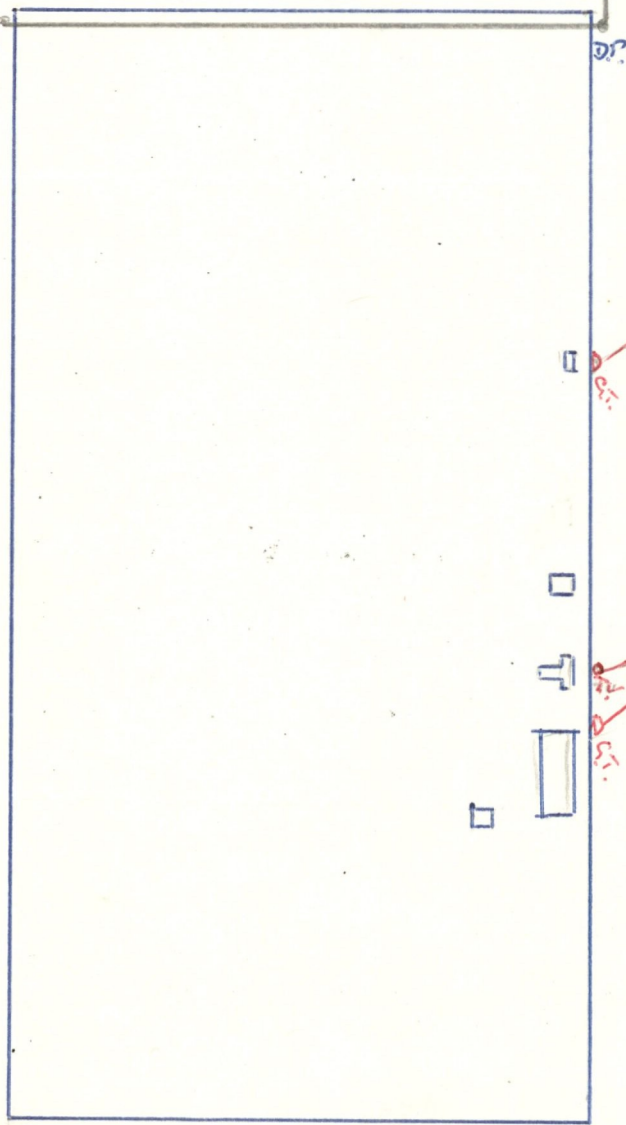

Name of Owner M. Treacy

Street Low Wayland & Viking Sts.

Lot or Section No. 40

Block No. G. 74. Ellins